

# AF-2

## Features

1. Lift safety valve, designed in compliance with JIS B 8210 "Spring loaded safety valves for steam boilers and pressure vessels".
2. Larger discharge capacity than lift type.
3. Due to lift lever mechanism a discharge inspection can be manually performed at more than 75% of the opening pressure.
4. Blowdown pressure can be adjusted with a back pressure throttle valve.
5. A material of excellent quality is used for the trim parts. High performance is maintained by precision processing and heat treatment.



## Specifications

Structure		Open type with a lever
Application		Steam
Working pressure		0.18-1.6 MPa
Maximum temperature		220°C
Material	Valve case	Ductile cast iron
	Spring case	Ductile cast iron
	Valve, valve seat	Stainless steel
Connection		Inlet: JIS B 8210 10K RF flanged * Outlet: JIS B 2239 10K FF flanged

\* JIS B 8210 20K RF flanged when working pressure is more than 1.0 MPa.

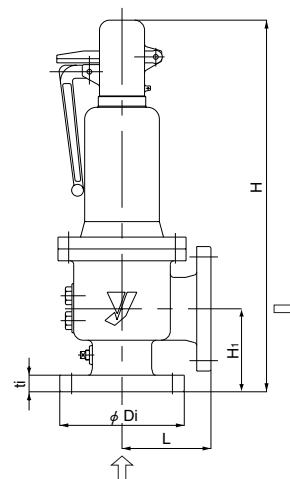

## Dimensions and Weights

Nominal size	Inlet diameter x Throat diameter x Outlet diameter	Flow area $\frac{\pi}{4} dt^2$ (mm <sup>2</sup> )	Lift $l$ (mm)	Dimension (mm)			Connection (mm)						Outlet	Weight (kg)
				L	H <sub>1</sub>	H	Inlet: JIS B 8210 10K							
							Di	Ci	gi	ti	fi	ni x hi		
65A	65 x 49 x 90	1884.7	11.1	150	142	630	200	160	105	30	2	8 x 23	100A	50.0
80A	75 x 57 x 100	2550.7	13.0	165	160	682	210	170	125	32	2	8 x 23		62.3

## Certified Capacity Table

### ●For steam (saturation temperature) <Pressure vessel structure standard>

(kg/h)

Pressure MPa \ Nominal size	0.2	0.3	0.4	0.5	0.6	0.7	0.8	0.9	1.0	1.1	1.2	1.3	1.4	1.5	1.6
65A	2467	3313	4171	4999	5821	6636	7444	8253	9067	9877	10684	11488	12300	13098	13907
80A	3339	4484	5645	6766	7878	8981	10074	11170	12271	13368	14460	15547	16647	17727	18821

### <Boiler structure standard>

(kg/h)

Pressure MPa \ Nominal size	0.2	0.3	0.4	0.5	0.6	0.7	0.8	0.9	1.0	1.1	1.2	1.3	1.4	1.5	1.6
65A	2429	3198	3978	4735	5505	6269	7033	7784	8547	9306	10063	10816	11578	12338	13096
80A	3287	4328	5385	6409	7451	8484	9518	10535	11567	12595	13619	14638	15669	16698	17725

• Please contact us for the calculation procedure for nominal size selection.